

01 Self-Sufficient Complex

Ryterna Modul of Cycling Tourism Complex Design

110746883



P1 SERVICE CENTER

Set up bike repair center and toilet for logistics service group, provide logistics support for riders and guests. Triangular solar photovoltaic panels and wooden flooring at the top define the public activity areas while providing bike maintenance and parking areas.

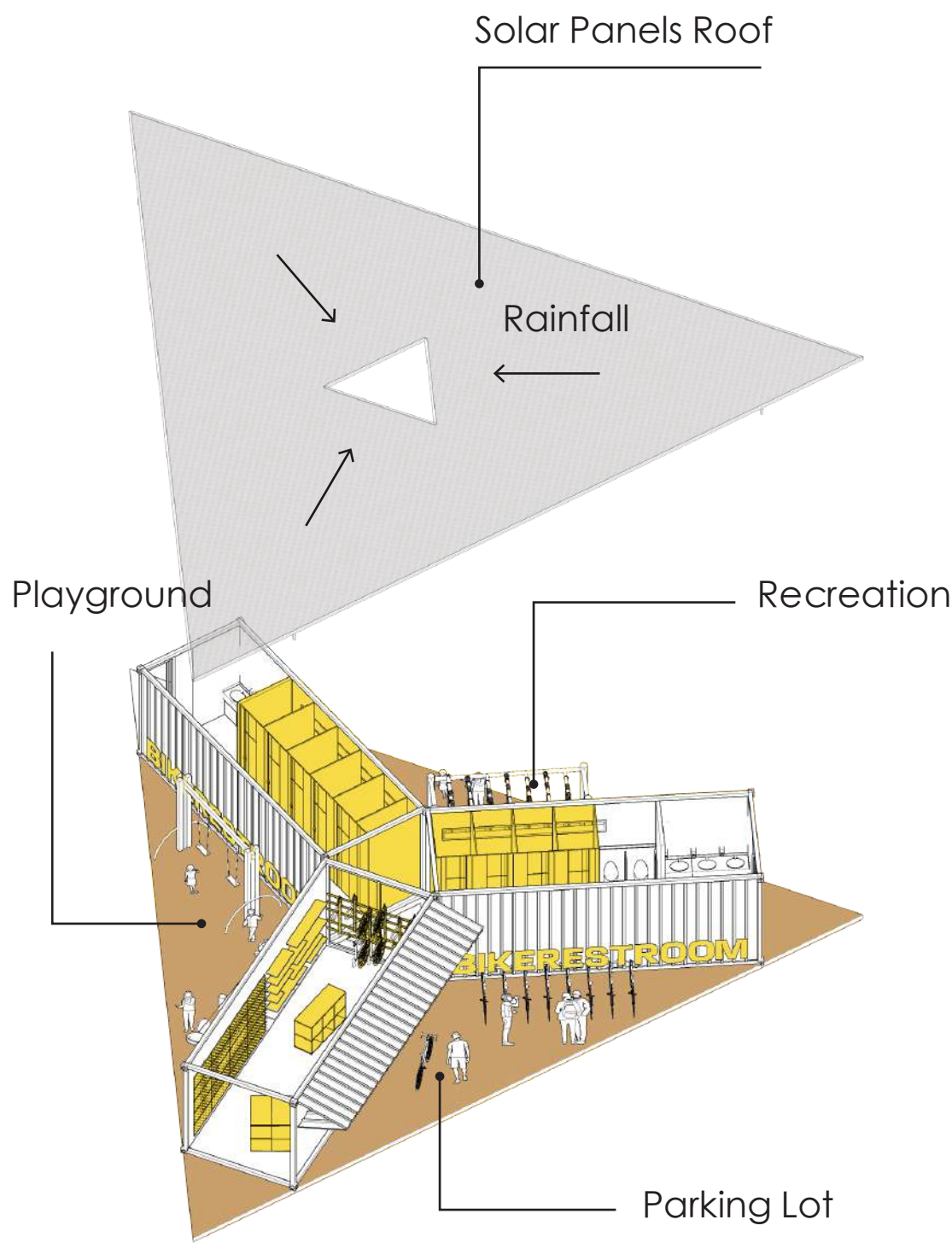
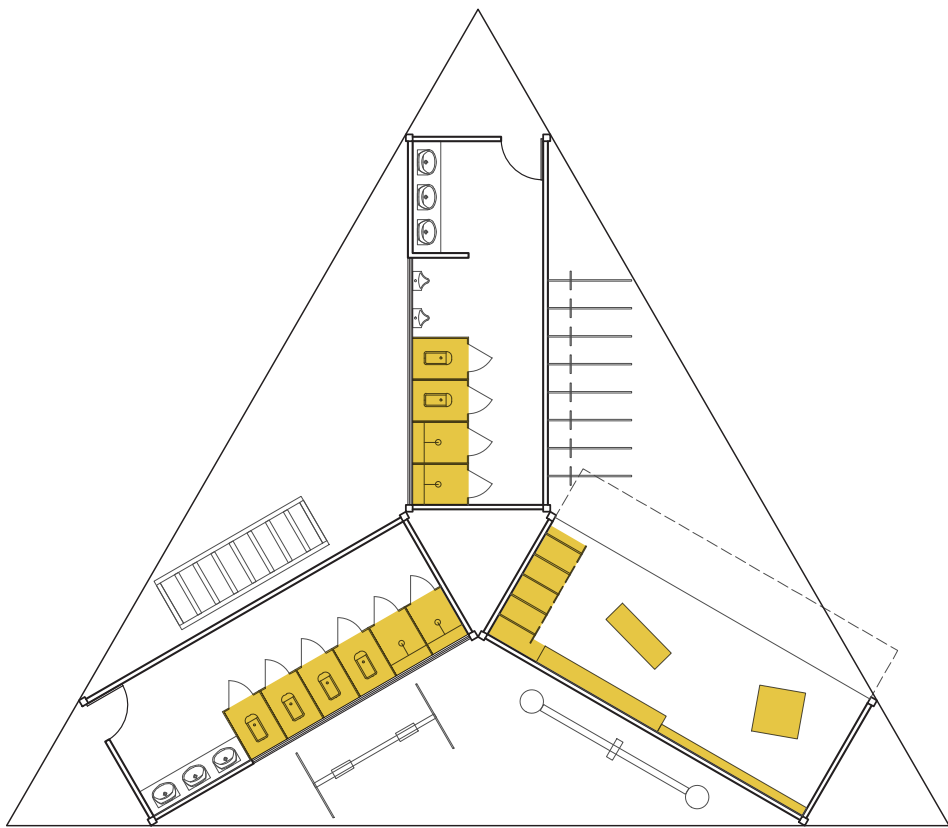

P2 RESTAURANT+KITCHEN

Four standard modules make up the business service cluster, equipped with Cafe/hotel/private fast food restaurant and executive service desk. The open kitchen provides buffet cooking service for cyclists. Square solar photovoltaic panels and wood flooring delineate four communal areas of different styles, providing space for commercial outways.

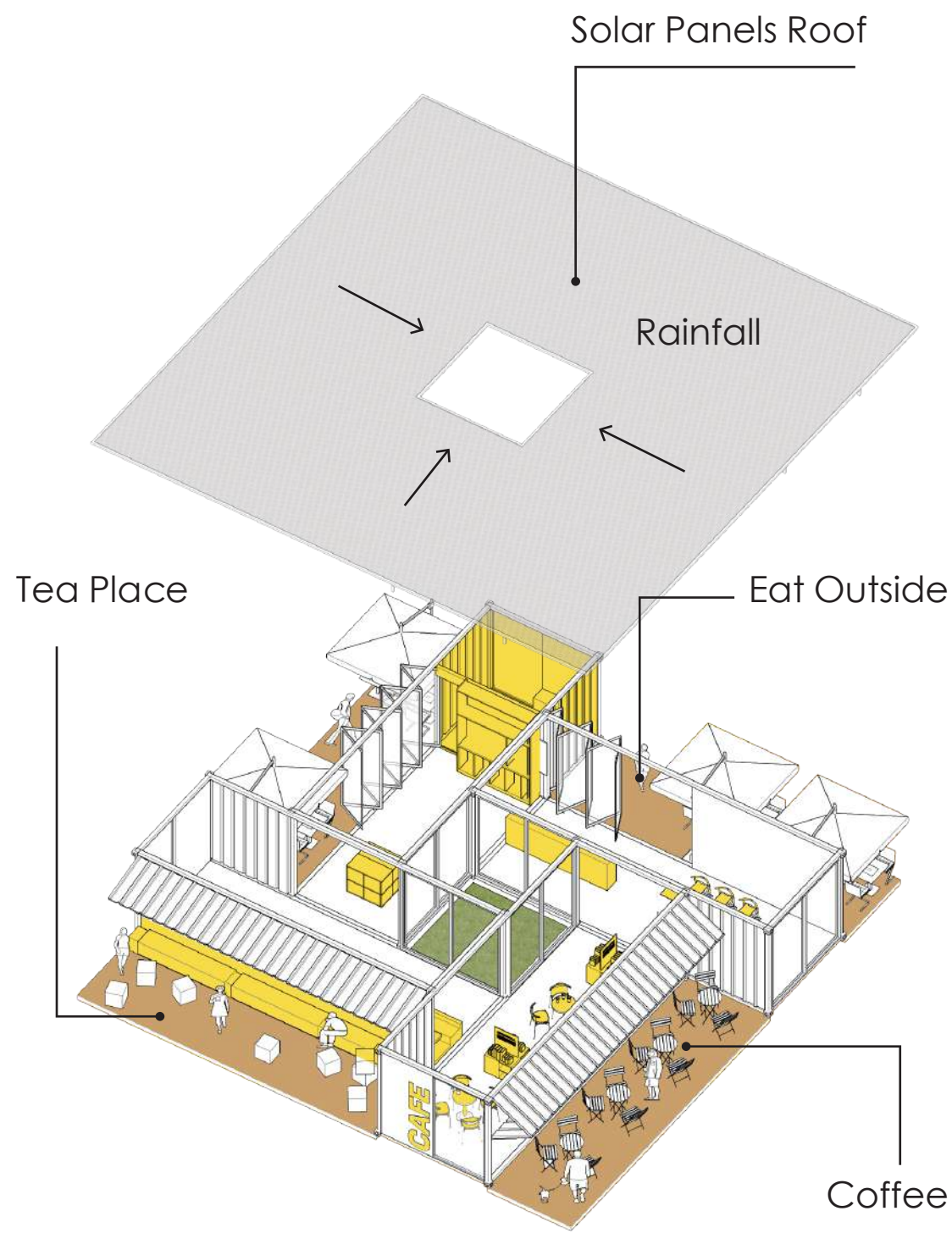
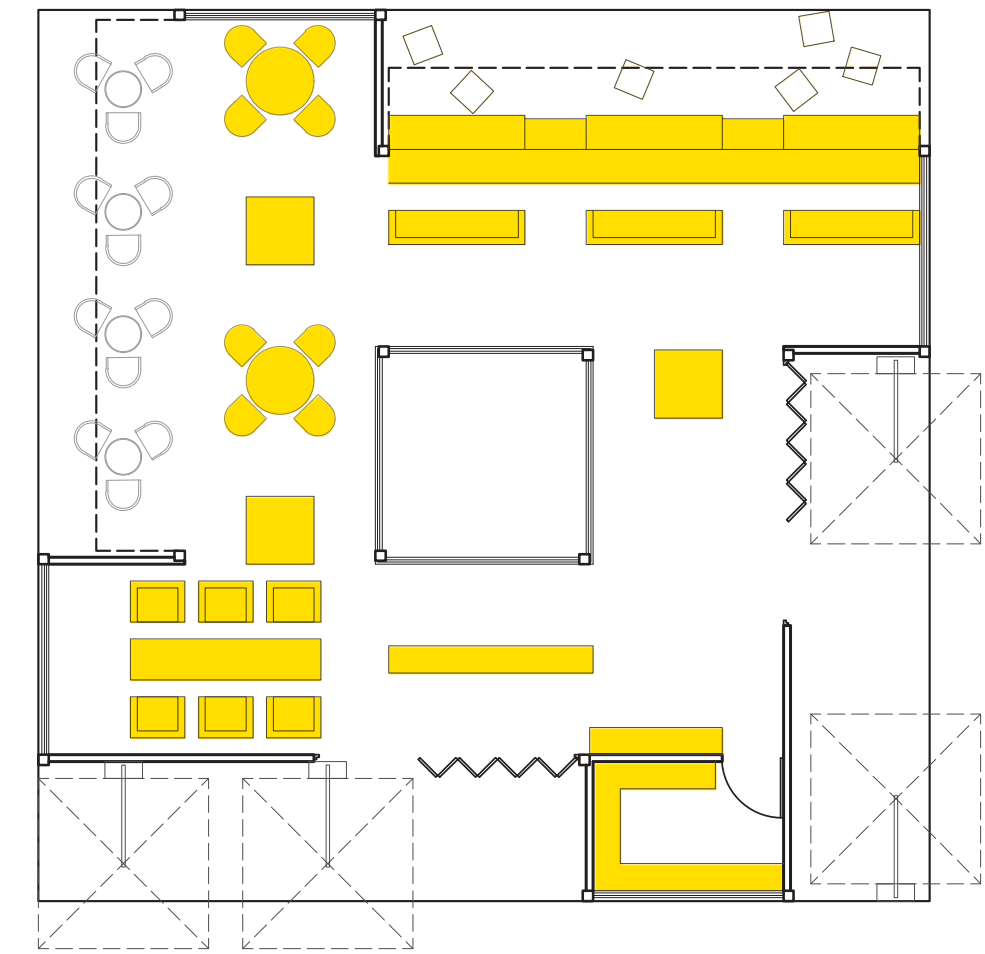

P3 HOTEL ROOMS

A separate bathroom module divides the interior space into a room facing the landscape and a living room facing the inner courtyard. The double bed on the top of the living room can be lowered by a lifting device to increase the capacity of the guest room to four people, while ensuring that there are two relatively independent private rooms. The circular roof and ground floor define four courtyard Spaces that serve the guest rooms.

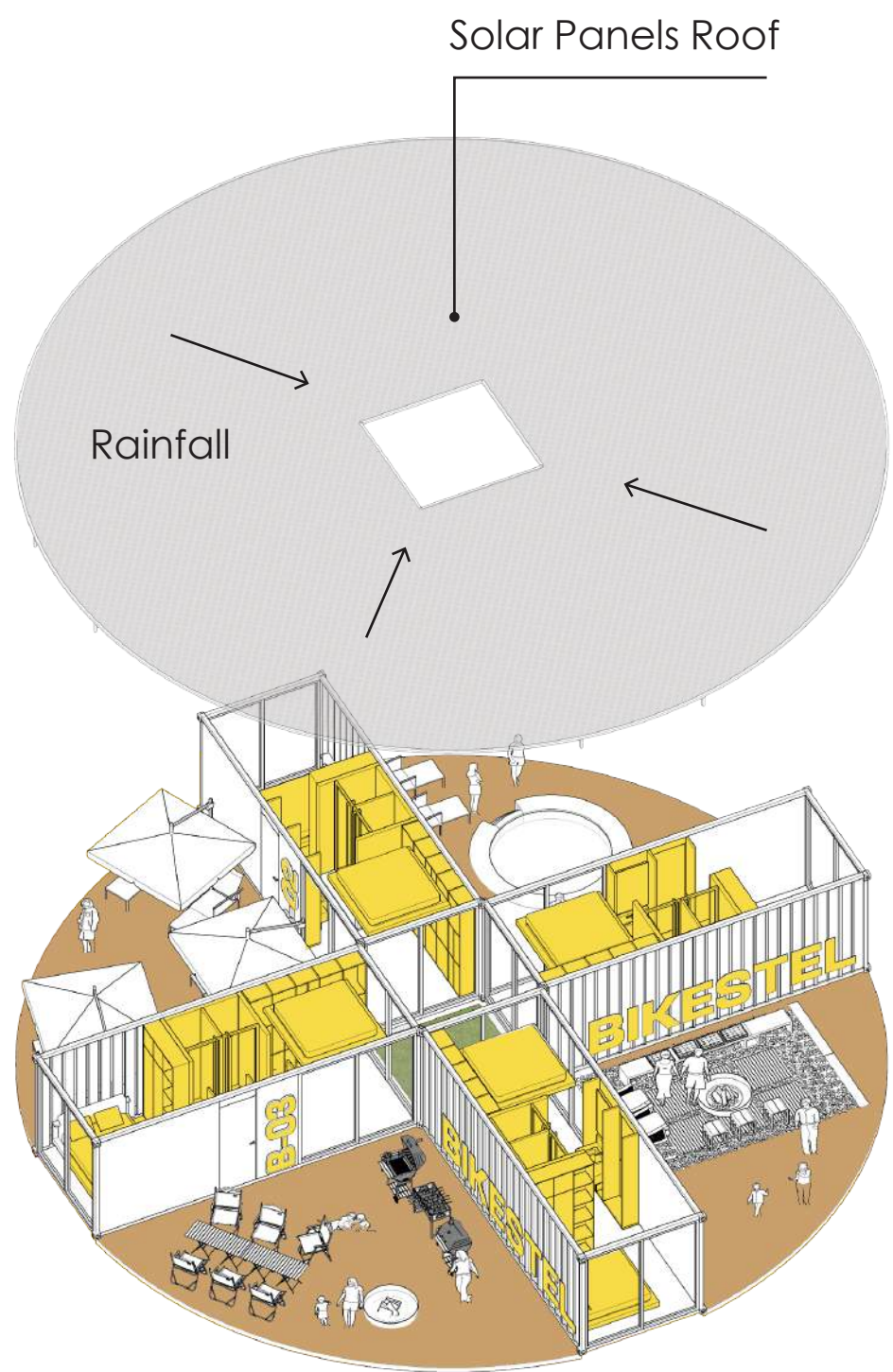
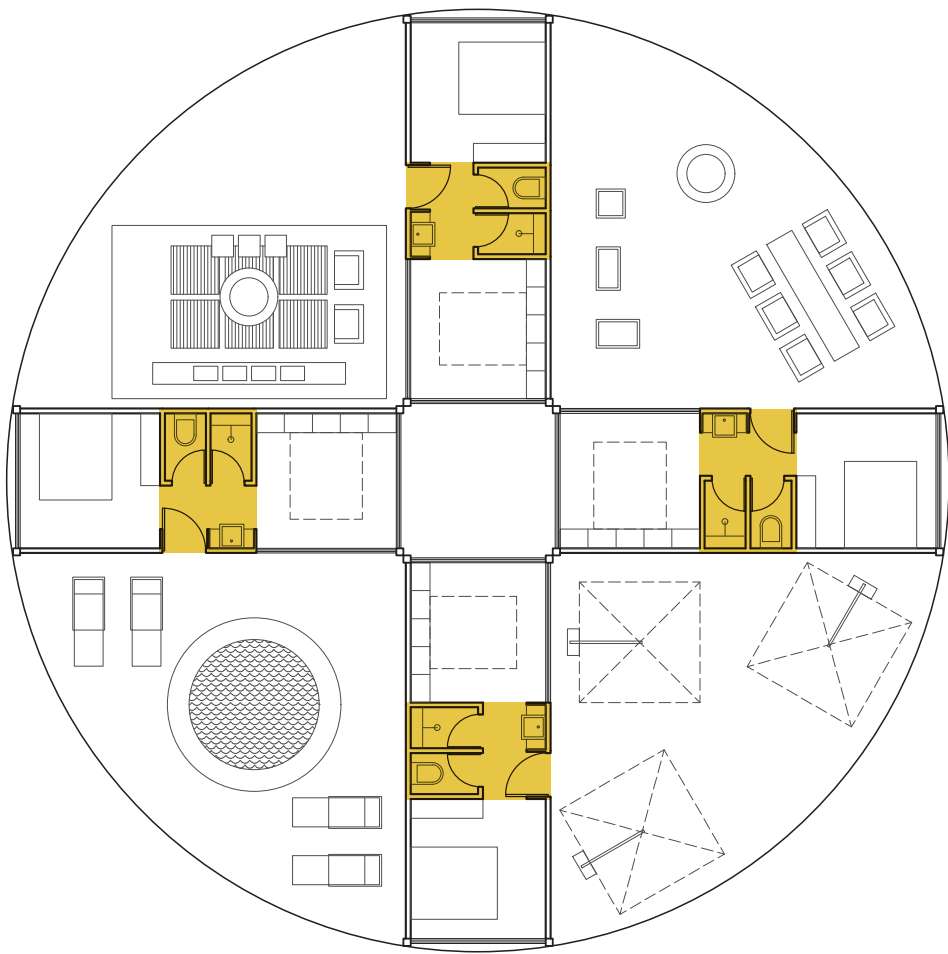

P4 BIKERS HOSTEL

Dormitory-style hotel rooms are grouped independently, each module has four built-in living units, which are equipped with lockers, desks for study and work and other facilities. Public storage cabinets and public activity space are reserved in the module. At the same time, the public activity area defined by the pentagonal roof and ground provides a more comfortable activity space for residents.

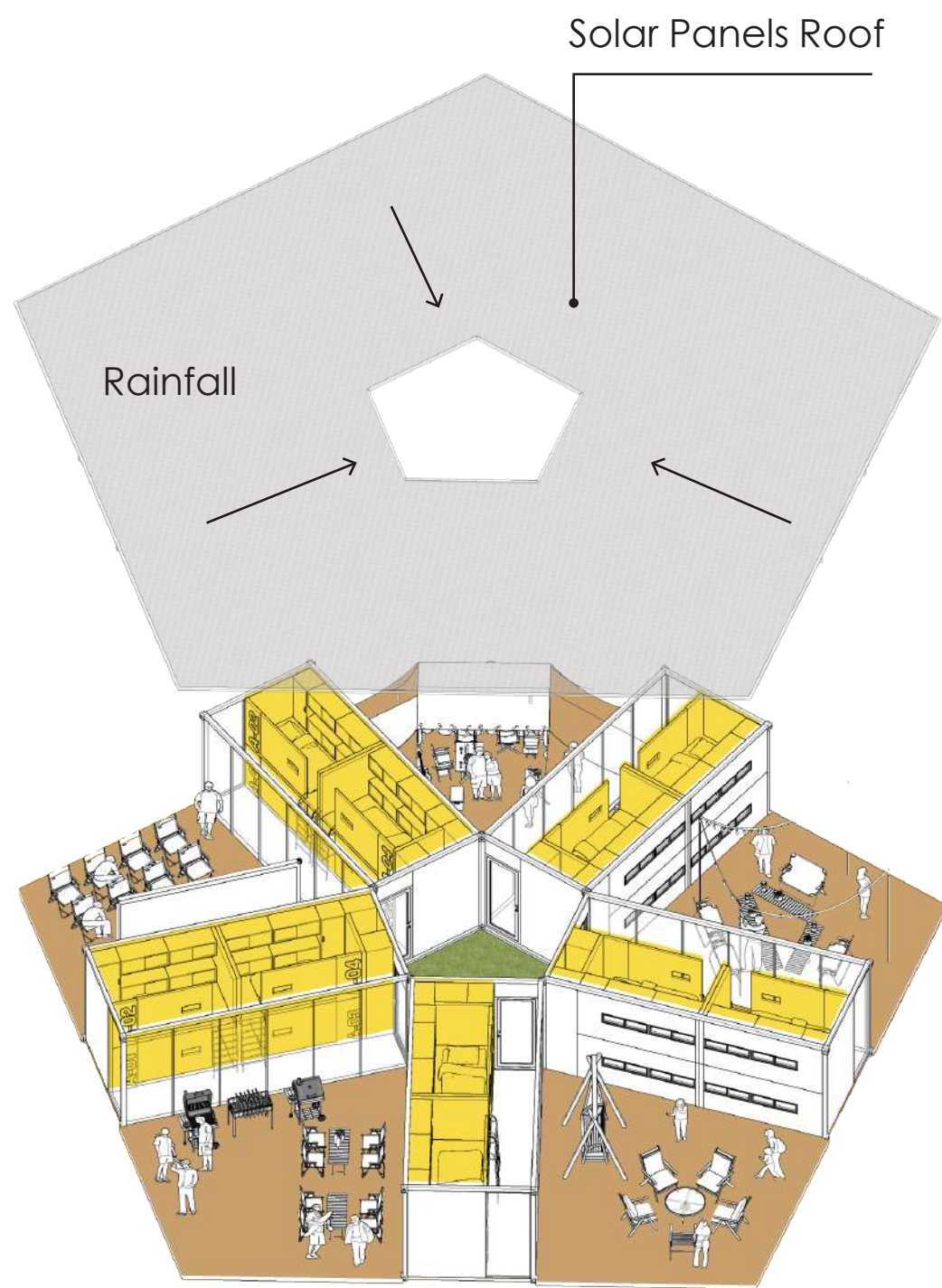

02 Self-Sufficient Complex

Ryterna Modul of Cycling Tourism Complex Design



01-Hostel 02-Hotel Room 03-Restroom 04-Bike Repair 05-Restaurant+kitchen

