

**Ryterna modul**  
**Architectural Challenge 2022**  
**Cycling Complex**

Presented project is a complex for cyclist travellers that include bicycle repair area, cafe, sauna unit, hostel and private hotel rooms that can be used for over-night stays.

The complex was designed with 14 Ryterna wooden units that were connected with each other with passages and roofs. All elements were elevated one meter above the ground on pile foundation to provide more privacy of the guests and so that the building has lower impact on the environment and natural habitats on the site.

The potential site for the project is a Amager Fælled Park in Copenhagen, which is an extensive green area in the city passed by many cyclists every day. It can be also easily implemented in other places.

The form was inspired by bicycle elements such as wheels and gears and by their circular movement.



Inspiration



Location



South - West facade



North - West facade



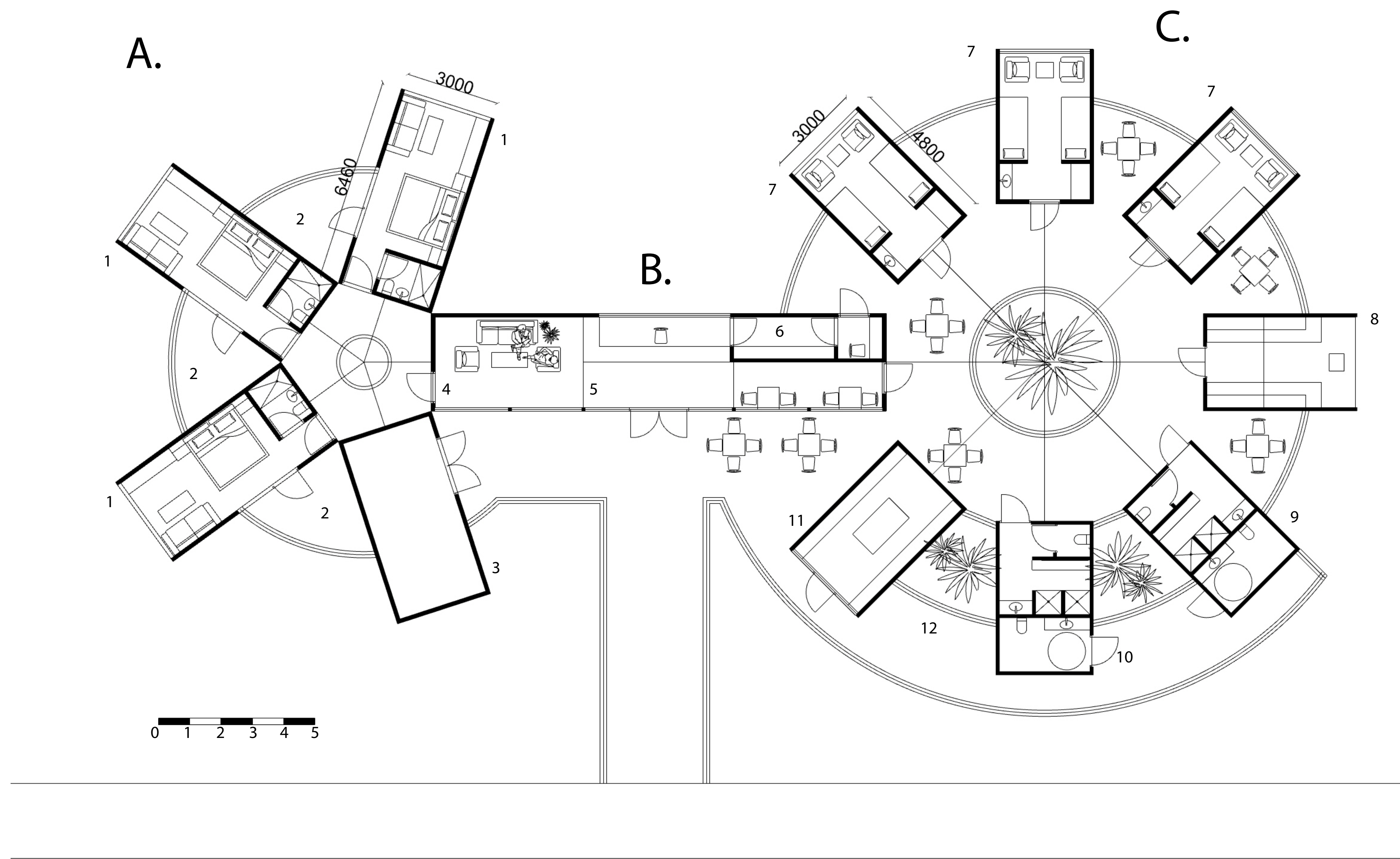

### A. HOTEL

- 3 units with private bathrooms and private terraces (3000mm x 6400mm)
- 1 unit with bike storage accessible from public area (3000mm x 6400mm)

### B. ENTRANCE AREA

- 3 units (3000mm x 4800mm) with reception, lounge area and small kitchen for a cafe

### B. HOSTEL AREA

- 3 sleeping units with bunk beds (3000mm x 4800mm)
- 1 unit with sauna (3000mm x 4800mm)
- 2 units with bathrooms both for hostel and public (3000mm x 4800mm)
- 1 unit with bicycle workshop (3000mm x 4800mm)

### LEGEND

- 1 - hotel room
- 2 - private terrace
- 3 - bicycle storage
- 4 - hotel lounge
- 5 - reception/cafe serving area
- 6 - kitchen
- 7 - hostel room
- 8 - sauna
- 9 - bathrooms (female)
- 10 - bathrooms (male)
- 11 - bicycle workshop
- 12 - bicycle parking







North - East facade



South - East facade